



# **Post Driver**

For

**Skid Steer Loaders**

**Operator's Manual**

**Set-Up Assembly**

**Maintenance**

**Parts Information**



**Read this Manual Before Use**

## TABLE OF CONTENTS

---

SAFETY	3-4
SERIAL NUMBER/DECAL LOCATION	5-6
USERS INSTRUCTIONS FOR MOUNTING THE POST DRIVER	7-8
OPERATING THE POST DRIVER	9-11
ROUTINE MAINTENANCE	12-14
SET UP ASSEMBLY	15-16
OPERATING POST DRIVER ON SIDE HILL	17
PARTS INFORMATION	18-23
GENERIC WIRE HARNESS INSTALLATION	24-25
GENERAL SPECIFICATIONS	26
WARRANTY	27

### REFERENCE INFORMATION

Write the correct information for your attachment in the spaces below. Always use these numbers when calling for service or parts.

Serial Number.....

### YOUR ATTACHMENT DEALER

---

ADDRESS:

---

PHONE:

---

CONTACT:

---

**NOTE:** *Erskine Attachments LLC reserves the right to make improvements in design or changes in specifications at any time without notice and without incurring any obligations to install them on units previously sold.*

## SAFETY

---

**DO NOT** use or perform maintenance on this machine until this manual has been read and understood. In addition, read the Operation and Maintenance Manual(s) pertaining to the attachment and the attachment carrier (“Loader”).

The user is responsible for inspecting the machine daily, and for having parts repaired or replaced when continued use of the machine would cause damage, excessive wear to other parts or make the machine unsafe for continued operation.

If an operating procedure, tool device, maintenance or work method not specifically recommended is used, you must satisfy yourself that it is safe for you and others. You must also ensure that the attachment will not be damaged or made unsafe by the procedures you choose.

Erskine Attachments LLC cannot anticipate every possible circumstance that might involve potential hazard. The safety messages found in this manual and on the machine are therefore not all inclusive.

The signal words **CAUTION**, **WARNING**, or **DANGER** are used to indicate hazards.

**⚠ CAUTION** Indicates a potentially hazardous situation which, if not avoided, may result in minor or moderate injury.

**⚠ WARNING** Indicates a potentially hazardous situation which, if not avoided, could result in death or serious injury.

**⚠ DANGER** Indicates a potentially hazardous situation which, if not avoided, will result in death or serious injury.

The word **IMPORTANT**, is used in the text when immediate damage will occur due to improper technique or operation.

The word **NOTE** is used to convey information that is out of context with the manual text; special information such as specifications, techniques, reference information, and other information of a supplementary nature.

**Call Before You Dig**  
**1-888-258-0808**



## Improper operation can cause serious injury or death.

### Pre-operation

- This attachment is designed to be used for the driving of posts into the ground. Posts must be smaller than 8" by 9" and shorter than the maximum height the loader can raise the post driver. **NEVER** use this machine for any other purpose.
- Read the operator's manual for the "Skid Steer Loader." **NEVER** allow untrained people to operate.
- Operating instructions must be given to everyone before operating this attachment and at least once a year thereafter in accordance with OSHA regulations.
- **NEVER** exceed the maximum recommended input power or speed specifications for the attachment. Over-powering or over-speeding the attachment may cause personal injury and/or machine damage.
- Keep all shields, guards, and covers in place.
- Do not modify equipment or add attachments that are not approved by Erskine Attachments LLC.
- Use adequate safety warning lights and devices as required by local regulations. Obey all local laws and regulations regarding machine operation on public property. Always call before you drive a post (1-888-258-0808). When you call, you will be directed to a location in your state/city for information about buried lines (electric, telephone, cable TV, water, sewer, gas, etc.).

### Operation

- Hydraulic connections may be hot after use. Use gloves if connecting or disconnecting after use.
- Check and be sure all operating controls are in neutral before starting the engine.
- To avoid electric shock or electrocution, **NEVER** operate the attachment near overhead power lines.

### Operation (continued)

- Keep body parts away from the attachment during operation and **NEVER** operate with shields removed. This attachment has moving parts.
- **NEVER** allow the assistant to be standing underneath attachment when in use.
- **NEVER** operate near embankments or terrain that is so steep that rollover could occur.
- Always stay in the operator position when using the attachment.
- Before leaving the operator's position, disengage hydraulic drive, lower the attachment to rest flat on the ground, stop engine, set park brake, and wait for all motion to stop.
- **NEVER** place hands near attachment or clear debris while the engine is running.

### Avoid High Pressure Fluids Hazard



- Escaping fluid under pressure can penetrate the skin causing serious injury.
  - Avoid the hazard by relieving the pressure before disconnecting hydraulic lines.
  - Use a piece of paper or cardboard, NOT BODY PARTS, to check for suspected leaks. Wear protective gloves and safety glasses or goggles when servicing or performing maintenance on hydraulic systems.
  - If an accident occurs, see a doctor immediately. Any fluid injected into the skin must be surgically removed within a few hours or gangrene may result.
- ### Maintenance
- **NEVER** make adjustments, lubricate, clean, or perform any service on the machine while it is in operation.
  - Make sure the attachment is serviced on a daily basis. Improper maintenance can cause serious injury or death in addition to damage to the attachment and/or your equipment.



# SERIAL NUMBER AND SAFETY DECAL LOCATIONS

## Serial Number Location:

It is important to refer to the serial number of the attachment when making repairs or ordering parts. Early or later models (identification made by serial number) may use different parts, or it may be necessary to use different procedures in doing a specific operation.

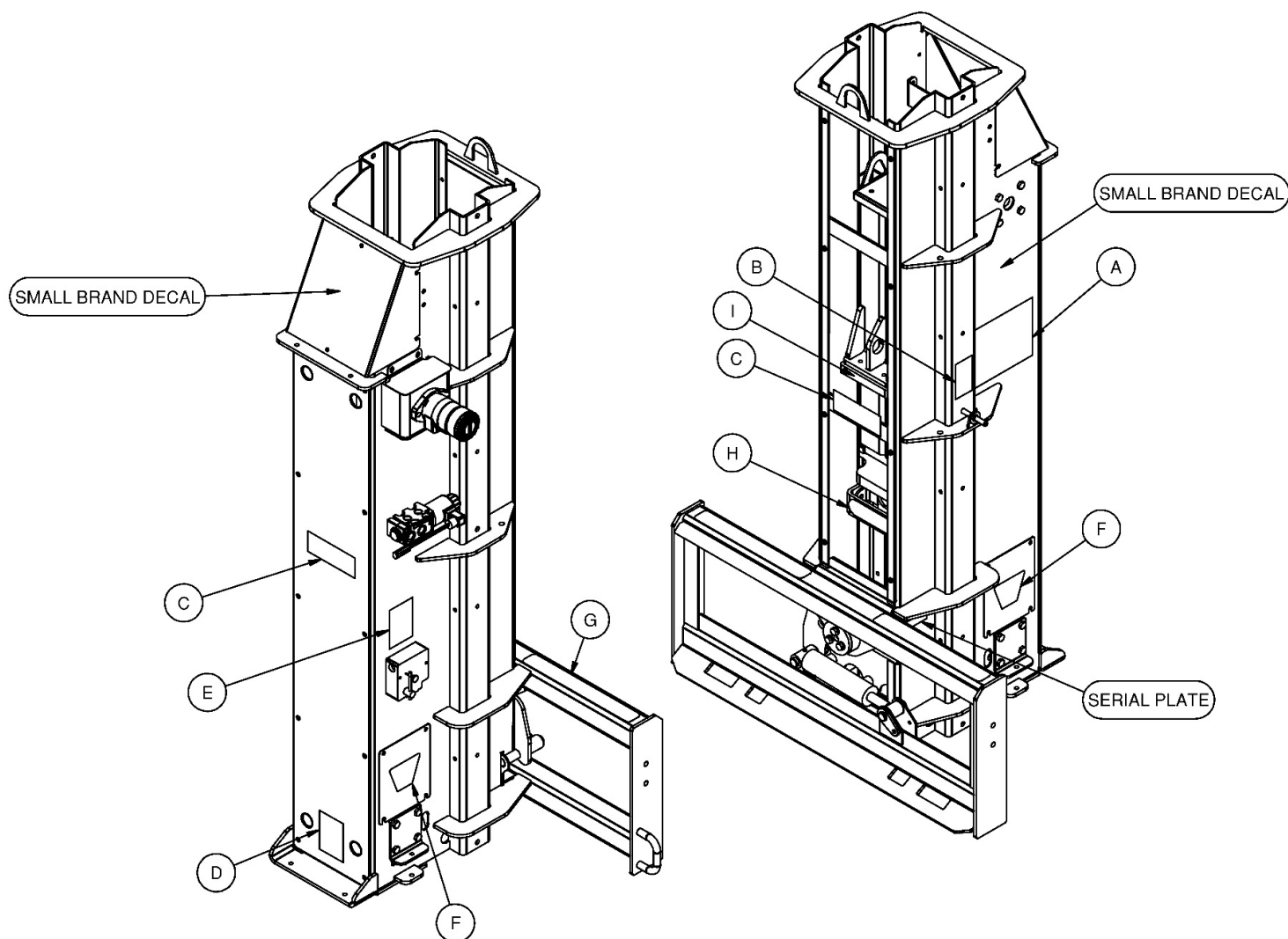

# SERIAL NUMBER AND SAFETY DECAL LOCATIONS

(A)

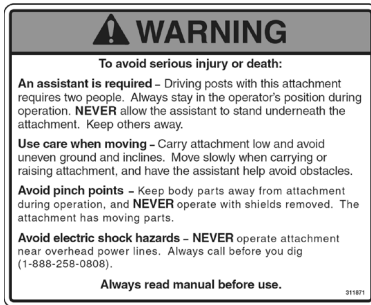

**Part Number: 311871**  
**Location:** On right side  
**Quantity:** 1

(B)



**Part Number: 313394**  
**Location:** On right side  
**Quantity:** 1

(C)



**Part Number: 313390**  
**Location:** On front & back clear shields  
**Quantity:** 2

(D)



**Part Number: 203234**  
**Location:** On front clear shield  
**Quantity:** 1

(E)



**Part Number: 200001**  
**Location:** by valve block  
**Quantity:** 1

(F)



**Part Number: 103206**  
**Location:** On each side  
**Quantity:** 2

(G)

**Part number: 202153 (Anti-skid tape 2 x 16)**  
**Location:** On top bar of mounting plate  
**Quantity:** 2

(H)

(I)

**Yellow Reflectors**  
**Part Number: 300245**  
**Location:** On collar and hammer stop  
**Quantity:** 1 of each

## Small Brand Decal

**Location:** front top shield & on side opposite motor  
**Quantity:** 2

## Safety Decals Locations:

The locations of the safety decals are shown. If these decals are missing, damaged, or painted over they must be replaced. Call Erskine Attachments LLC (218-435-4045) for replacement decals.

# USER'S INSTRUCTIONS FOR MOUNTING THE POST DRIVER

After the initial set-up assembly is completed, use the following procedure to mount the attachment to the loader for user operation.

**⚠ WARNING** Coupler wedges or pins must extend through the holes in the attachment mounting plate. Levers must be fully down and locked. Failure to secure wedges or pins can allow attachment to come off and cause injury or death.



1. Use the steps, safety treads, and grab handles to get on and off the loader and post driver.

2. Sitting in the operator's seat, lower seat bar and fasten the seat belt.

3. Drive the loader to the rear of the attachment. Put the loader quick attach coupler into the attachment mounting bracket.

4. Tilt the loader coupler backward a small amount until it is fully engaged in the attachment mounting bracket.

5. Stop the engine and engage the park brake.

6. Secure the coupler locking mechanism that attaches the attachment to the loader.



## USER'S INSTRUCTIONS FOR MOUNTING THE POST DRIVER

7. Connect the hydraulic quick couplers from the attachment to the loader.

**IMPORTANT:** Make sure the quick couplers are fully engaged. If the quick couplers do not fully engage, check to see that the couplers are the same size and brand. Do not force the quick couplers together.

**IMPORTANT:** Wipe the ends of the hydraulic quick couplers (both lead and loader) with a rag to remove any possible contamination. Contamination can cause hydraulic components to fail and is not covered under warranty.

**NOTE:** See the loader's operator's manual.

**NOTE:** Attachment is shipped with 12FJX (1-1/16" Female JIC Swivel) fittings on the ends of the lead hoses.

8. Connect the wire harness to the loader's wire harness receptacle. (Disregard if a pistol grip controller is supplied with the attachment.)

Make sure the hoses are properly routed to fit your specific loader. If the hoses are not routed correctly, hoses may get pinched or rub on tires. Be sure to check the hose routing through the full range of intended motion of the attachment before operating it.

More than one routing may be acceptable depending on the loader. Pick the routing that best suits your loader.

**IMPORTANT:** Proper hose routing is the responsibility of the owner and/or operator. Pinched or stretched hoses are not covered under warranty.

Mounting is now complete and you are ready to use the attachment. Use the above instructions in a reverse order to dismount the attachment from the loader.

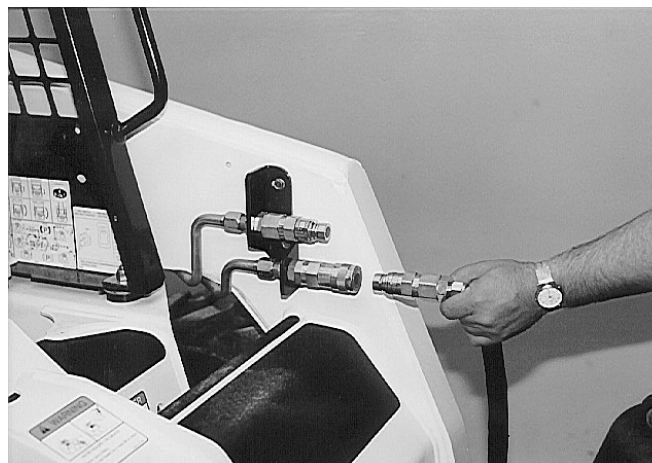



**⚠ WARNING** To avoid injury or death, **NEVER** operate attachment near overhead power lines.

**IMPORTANT:** Do not operate the post driver at excessive speeds. Using the flow control valve, start with a setting of 5 and adjust from 1 (slowest) to 10 (fastest) as needed. Severe damage will occur if the speed of the motor is greater than the speed of the hammer dropping to contact post.

**IMPORTANT:** Running motor backwards can result in damage to attachment. The chain must run in the direction that lifts the hammer up.

**IMPORTANT:** DO NOT use high flow hydraulics to run the post driver if loader is equipped.

**IMPORTANT:** Make sure the Transport Hammer Lock Pin is removed (see left).

**NOTE:** Maximum engine RPM is not required or recommended to run the post driver efficiently. Operator experience will help you determine the best speed at which to run the post driver.

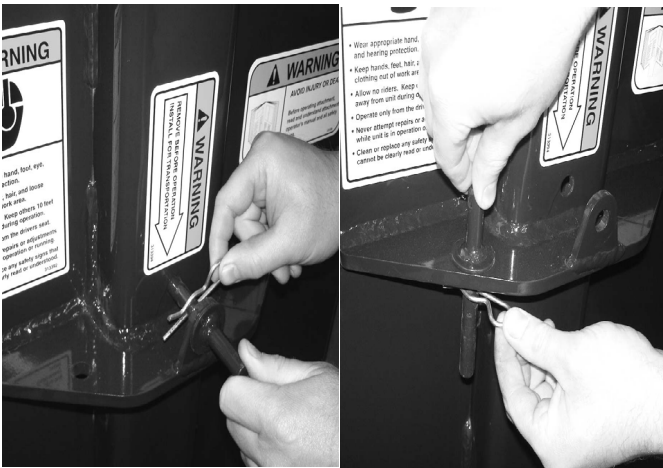

1. With the operator in the seat of the loader, the seat belt fastened and the seat bar lowered (if so equipped), start the engine.
2. Determine the desired location for the post to be driven into the ground. Driving posts requires two people: an operator in the loader and an assistant to handle the posts. Have the assistant hold the post upright and the operator will raise the post driver above the post and slowly drive forward over the post.

**⚠ WARNING** NEVER allow the assistant to be standing underneath attachment when in use.

3. The assistant will guide the post into the post driver collar as the operator slowly lowers the post driver onto the post. The assistant will then back away from the post driver at least 10 ft.



## OPERATING THE POST DRIVER

4. The operator will lower the post driver so the hammer is pushed up at least 24" by the post.

**IMPORTANT:** To avoid damage, maintain at least 12" of post engagement into the post driver at all times as shown in picture [A]. Good operating practice for post engagement is shown in picture [B]. Do not allow the hammer to bottom out on the frame while driving posts as shown in picture [C].

**NOTE:** Take time to get the post plumb before you start driving the post.

5. The assistant will use hand signs to aid the operator in achieving a plumb post driver and post. The assistant will signal the operator to get the post driver vertical in his view by having the operator adjust the roll out of the loader.
6. The operator will be able to turn the loader left or right to adjust the post side to side to achieve a vertical position. The operator should use the tilt function to make the post driver plumb.
7. The assistant will signal operator to drive the loader forward or backward to adjust the post front to back to achieve a vertical position.
8. Now that the post is plumb you may begin driving the post into the ground.

**NOTE:** Depending on ground conditions and post size, the post may go down into the ground 1" to 16" per hit.

**NOTE:** The post driver will drive blunt posts into ground. If the ground is hard the posts may have points cut into them.

**NOTE:** An optional ballast package may be purchased to increase hammer weight. This helps to drive large posts and/or posts into hard ground.

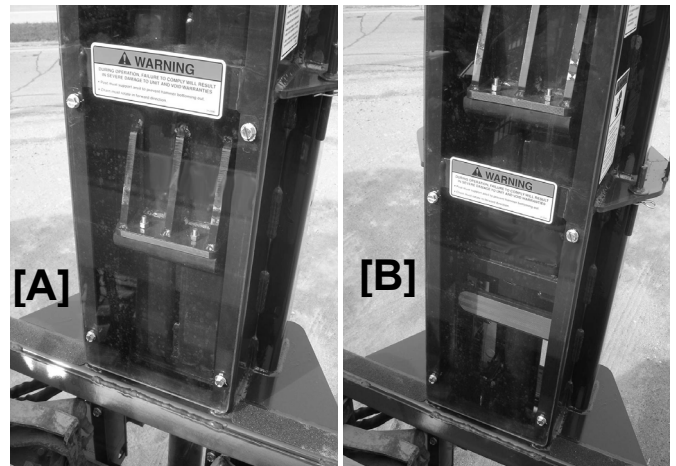

**Hammer lift finger.**

**Lift link will travel upwards when lifting the hammer.**



9. Drive the post until the post driver needs to be lowered to maintain the 12" minimum post engagement with the post driver. Then, stop the post driver motor and lower the post driver so the post engagement is approximately 24".
10. With the assistant still providing signals to keep the post plumb, repeat step 9 as needed until the post is driven into the ground to the desired height.
11. When moving between post sites, make sure the hammer is in the bottomed out position and carry the post driver low.

**IMPORTANT:** Install the Transport Hammer Lock Pin when done driving posts.



# ROUTINE POST DRIVER MAINTENANCE

**⚠ WARNING** Lower the attachment to rest, shut down the engine, relieve the hydraulic pressure to the attachment, wait for all motion to stop, and set park brake before leaving the operator's seat to perform service of any kind.

It is the operator's responsibility to make daily inspections of the loader and attachment for damage, loose bolts, fluid leaks, or anything else that could cause a potential service or safety problem. Preventive maintenance is the easiest and least expensive type of maintenance.

**IMPORTANT:** Bolts and set screws can loosen after initial usage. After the first hour of operation check all bolts and set screws.

## LUBRICATION

### Lubrication Legend



Multipurpose spray lube



No. 2 Lithium base gun grease



Clean engine oil



Intervals at which lubrication is required

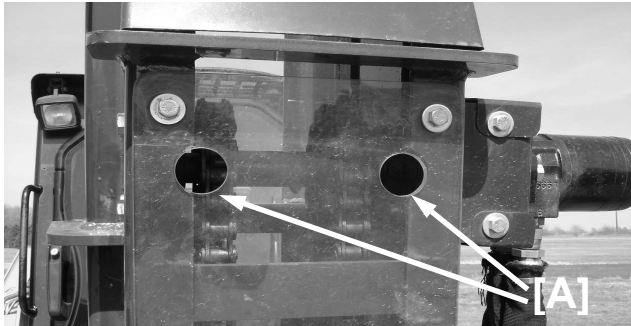

Use No. 2 lithium base gun grease when lubricating all attachment grease fittings.

Grease to the 2 top bearings [A] of the lift chain through the clear shield access holes after every **40 hours** of operation. Add no more than 2 pumps of grease at a time.



Grease the 2 bottom bearings [B] of the lift chain through the clear shield access holes after every **40 hours** of operation. Add no more than 2 pumps of grease at a time.

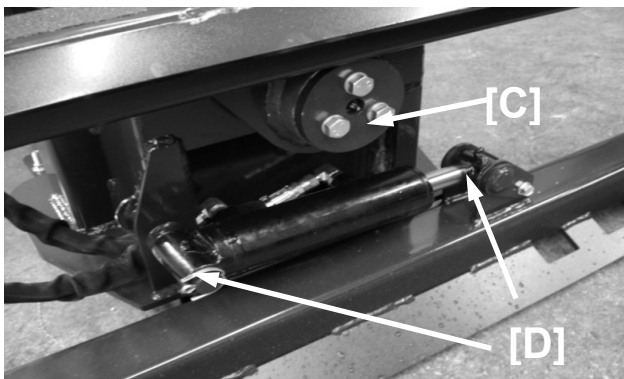
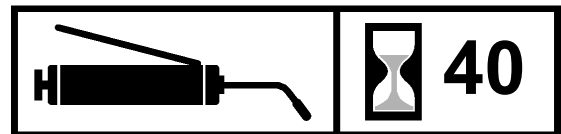

Grease the main pivot joint [C] and the 2 cylinder pins [D] after every **40 hours** of operation.



## Lubrication (continued)

Grease the chain lift link bushing **[E]** through the side plate access hole after every **8 hours** of operation.

**NOTE:** To line up the chain lift link grease zerk to the access hole the following procedure needs to be done. Energize the motor hydraulics in the forward direction and run until the hammer is being lifted up. Stop the post driver motor. The hammer will go back down by itself until it rests on the hammer stop. The chain lift link grease zerk is now in the access hole and can be greased.

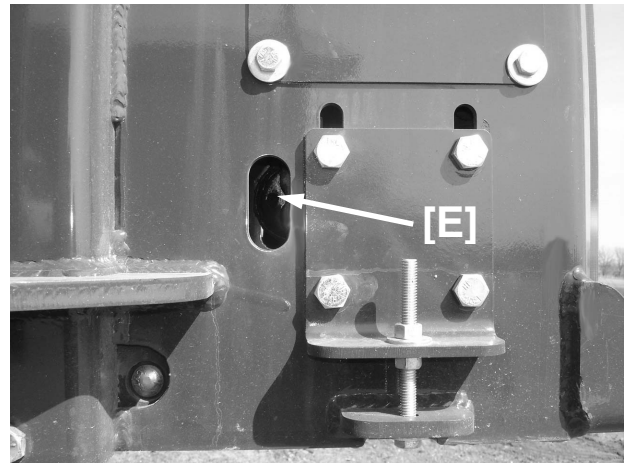

Grease the hammer guide channels through the side plate access holes after every **8 hours** of operation. The hammer needs to be located behind the hole for the grease to spread out properly in the channel.

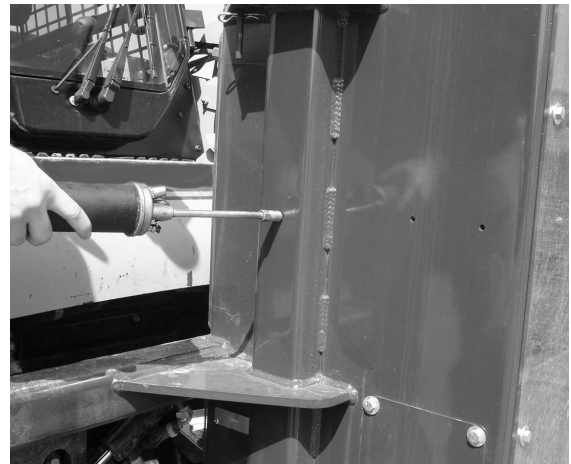
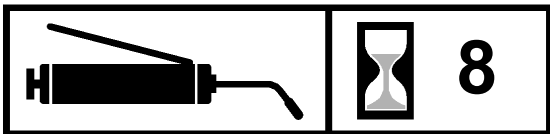

Use clean engine oil on the lift chains **[G]** after every **40 hours** of operation.

**IMPORTANT:** To avoid damage, do not dry fire the post driver while oiling the chains.

Oil the chains through the clear shield access holes while the operator slowly engages the motor to turn the chains.

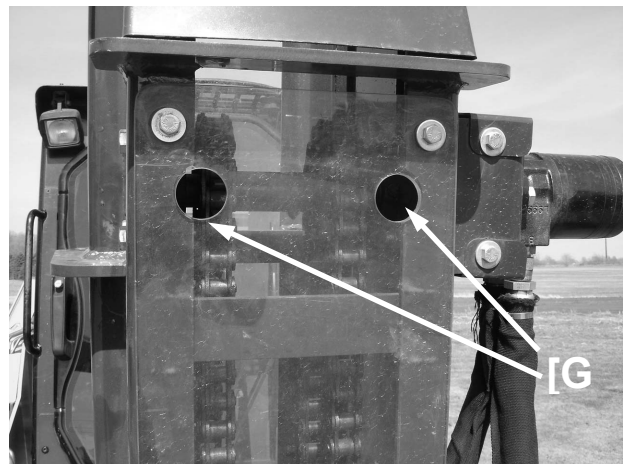
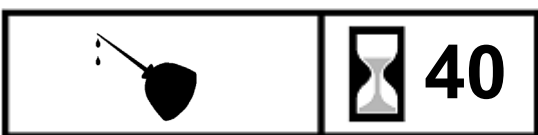

# ROUTINE POST DRIVER MAINTENANCE

---

## Lift chain adjustment

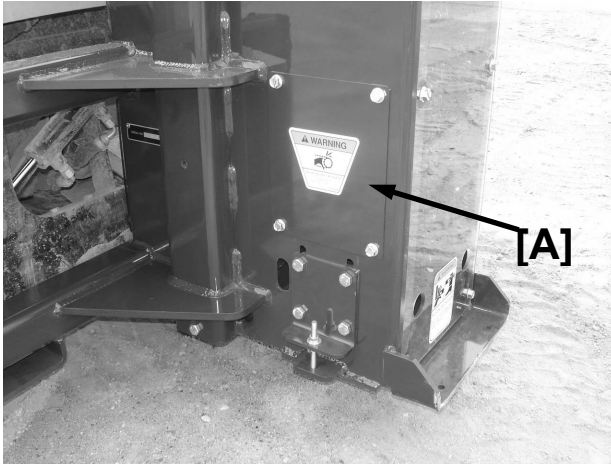

1. Remove the 2 top bolts securing the lift chain cover. Loosen the 2 bottom bolts of the cover. Remove the cover [A]. Repeat on the other side of the post driver.

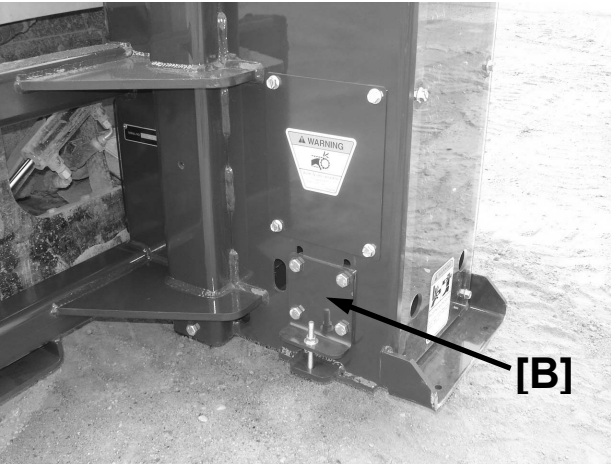

2. Loosen the 4 bolts on the flange bearing slide [B]. Repeat on the other side of the post driver.

3. Loosen the bottom [D] jam nut in order to turn the top [C] jam nut down to tighten the lift chain. Repeat on the other side of the post driver. Be sure to tighten both sides equally.

**IMPORTANT:** Do not overtighten lift chains. Tighten only enough to remove slack.

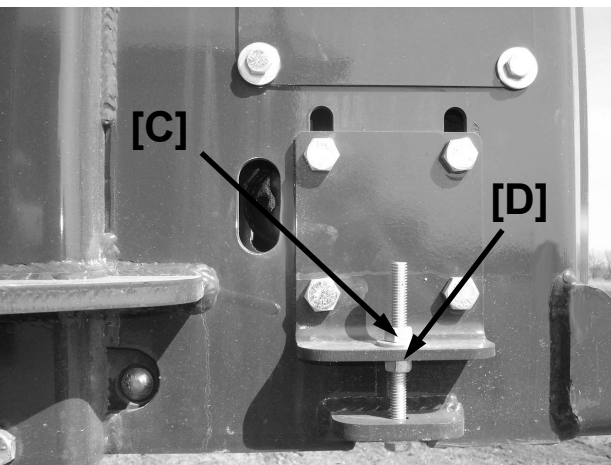

4. Tighten the bottom jam nut against the top jam nut. Tighten the flange bearing slide bolts. Repeat on the other side of the post driver.

5. Reinstall both lift chain covers.

# SET UP ASSEMBLY FOR POST DRIVER

## Sizing proper collar

The post driver has 3 different collar sizes to provide the most effective post driving possible through a wide range of post shapes and sizes.

### Square Collar:

The post driver cannot be operated without this collar in place. The inside dimensions of this collar are 8.5" by 9.5". Small posts may be driven with this collar but the post will be difficult to keep plumb.

**NOTE:** The collar should have a one half inch of clearance all the way around the post. If the post is tight on the collar, damage to the collar may occur.

### Round Collar:

The inside dimension of this collar is a 6" diameter. This collar is bolted into the square collar with 4 bolts.

**IMPORTANT:** Do not work under a raised post driver. Roll the post driver out so it is horizontal, lower it to the ground, and disconnect from the loader. The collar area is very accessible in this position.

**NOTE:** The collar should have a one half inch of clearance all the way around the post. If the post is tight on the collar, damage to the collar may occur.

### Tee Post Collar:

This collar does not attach to the post driver. The inside dimension of this collar is a 3" diameter. When driving tee posts this collar prevents the end of the post from mushrooming. The assistant will put this collar over the tee post and then guide it into the round collar of the post driver.

**NOTE:** The tee post collar works best with the round collar installed on the post driver.

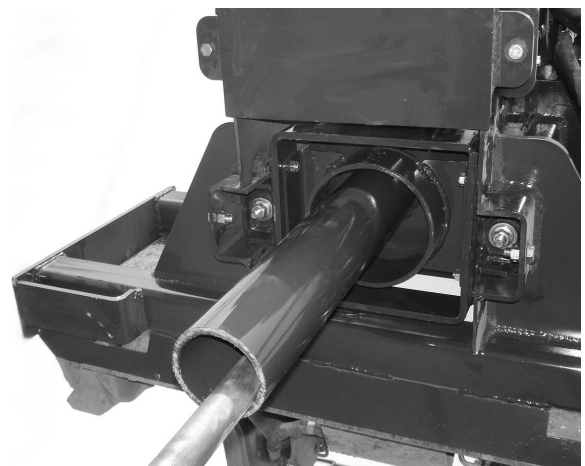

## SET UP ASSEMBLY FOR POST DRIVER

---



### Ballast option installation

A ballast option is available to add weight to the hammer for driving large posts.

If you buy this option from the factory, the steel shot will be pre-installed in your hammer from the factory.

If you initially buy your post driver without the steel shot and want to add it later use the following process to install the steel shot:

1. Remove the rear clear shield.
2. Remove the hammer cover.
3. Use a funnel to direct the shot into the square tubing of the hammer until each of the four tubes and center cavity are full. You may have a few pounds of shot left over.
4. Reinstall the hammer cover and clear shield.



**⚠ WARNING** Do not operate the post driver without the plastic shields installed.

# OPERATING POST DRIVER ON SIDE HILL WITH TILT FUNCTION

**⚠ WARNING** To avoid injury or death due to tipping, always keep the post driver in a low position when moving from post to post.

**⚠ WARNING** To avoid injury or death due to tipping, refer to the skid steer loader owner's manual for manufacturer's recommendations for operation on hilly and/or uneven terrain. The post driver weighs 1000 lbs. without ballast and 1200 lbs. with ballast, and can tilt up to 18° in either direction. Not all skid steer loaders will be able to drive a post on an 18° side hill. Use care when raising the post driver above the post and when the hammer is raised during operation – this will make the post driver top heavy.

**IMPORTANT:** Do not attempt to tilt while driving a post. Always stop hydraulic flow before operating tilt function.

**NOTE:** Skid steer loader controls vary from machine to machine. Read the loader operating instructions to become familiar with the loader control functions. Certain loaders may require a special harness jumper wire to operate correctly.

The post driver is equipped with an electrically actuated diverter valve which can send oil to one of two paths. The primary (default) path is to the hydraulic motor that raises the hammer. The secondary path is to the tilt cylinder.

## Operating the tilt function

1. Stop auxiliary hydraulic flow.
2. **Push and HOLD** the button that energizes the diverter valve. (usually on left handle)
3. Momentarily operate auxiliary hydraulic flow in forward or reverse direction to achieve desired tilt angle.
4. De-energize the diverter valve.
5. Resume normal operation.



**PUSH AND HOLD TO ENERGIZE DIVERTER**



**PUSH AND HOLD TO ENERGIZE DIVERTER  
(OPTIONAL PISTOL GRIP HARNESS SHOWN)**



**OPERATE AUXILIARY HYDRAULICS TO TILT**

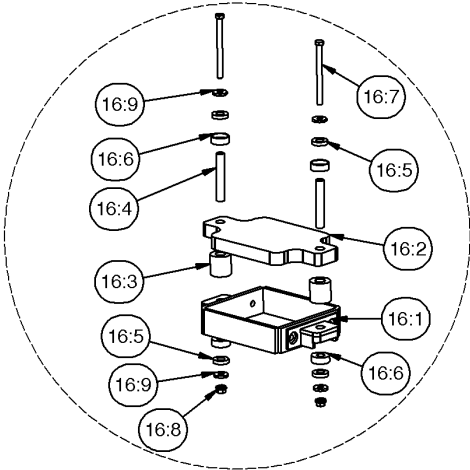



# MAIN ASSEMBLY

ITEM	QTY	PART NO.	DESCRIPTION	STOCK NO.
1	1	313463	FRAME TILT W/A	
2	1	313465	MOUNT FRAME W/A	
3	1	313303	HAMMER W/A	
4	1	422143	MOUNT FRAME EURO W/A	<b>FOR EURO ONLY</b>
6	1	313312	HAMMER CATCH W/A	
7	1	313389	PLATE HAMMER COVER W/A	
8	1	313306	COLLAR TEE POST W/A	
9	1	313309	COLLAR 6" ROUND W/A	
10	1	313382	PLATE HAMMER STOP PAINTED	
11	2	313386	PLATE CHAIN TIGHTENER PNT	
12	2	313388	PLATE COVER PAINTED	
13	2	313471	PLATE SHIELD MOTOR PAINTED	
14	1	313379	PLATE SHIELD TOP PAINTED	
15	1	313538	PLATE PIVOT KEEPER PAINTED	
16	1	313308	ANVIL COLLAR ASY	
	1	313338	PKG ANVIL COLLAR PARTS ONLY	<b>PARTS ONLY</b>
16:01	1	313301	COLLAR 8.5" X 9.5" W/A	
16:02	1	313398	PLATE ANVIL PAINTED	
16:03	2	313384	BUSHING COLLAR	
16:04	2	313480	TUBE ANVIL BUSHING	
16:05	4	313385	WASHER RUBBER	
16:06	4	313498	CUP WASHER	
16:07	2	15225	BOLT HEX	1/2 X 6 - UNC - GR 8
16:08	2	167011	NUT FLG TOP-LOCK	1/2 - UNC - GR 8
16:09	4	313321	WASHER .53ID X 1.375OD X .199	
23	1	313355	SEAL HAMMER COVER	
24	1	313352	SHIELD REAR	
25	1	313354	SHIELD FRONT	
26	1	313380	BUMPER STOP	
33	1	313460	PIN 1 X 2.5 W/A	
35	1	200064	PIN CLIP	PIN CLIP #11 1/8 X 2-5/8
36	1	65127	PIN COTTER 3/16 X 2	
39	39	32467	BOLT FLG THRD RLNG	3/8 X 3/4 - UNC - GR 5
40	4	103116	BOLT HEX	3/8 X 1 - UNC - GR 5
41	2	103879	BOLT HEX	3/8 X 1.5 - UNC - GR 5
42	2	13819	BOLT HEX	3/8 X 3.5 - UNC - GR 5 FULL THD
43	2	13205	BOLT HEX	1/2 X 1 - UNC - GR 5
44	11	13207	BOLT HEX	1/2 X 1.25 - UNC - GR 5
45	4	15207	BOLT HEX	1/2 X 1.25 - UNC - GR 8
	4	21817	BOLT CARRIAGE	3/8 X 1 - UNC - GR 5 - <b>OLD STYLE ONLY</b>
46	8	13209	BOLT HEX	1/2 X 1.5 - UNC - GR 5
47	2	33008	WASHER FLAT	3/8 - USS - GR 5
50	4	36306	NUT HEX	3/8 - UNC - GR 5 - REG GR 5
51	2	37212	NUT HEX	3/8 - UNC - GR 5 - REV LOCK
53	20	37214	NUT HEX	1/2 - UNC - GR 5 - REV LOCK
54	4	167011	NUT FLG TOP-LOCK	1/2 - UNC - GR 8
55	4	33006	WASHER FLAT	5/16 - USS - GR 5
56	4	103880	WASHER LOCK	0.375 - GR 5
57	3	33626	WASHER LOCK	0.5 - GR 5
58		313370	BALLAST 50LB BAG	<b>PART OF PKG 313376 (200LB BALLAST OPTION)</b>

# POST DRIVER PARTS INFORMATION

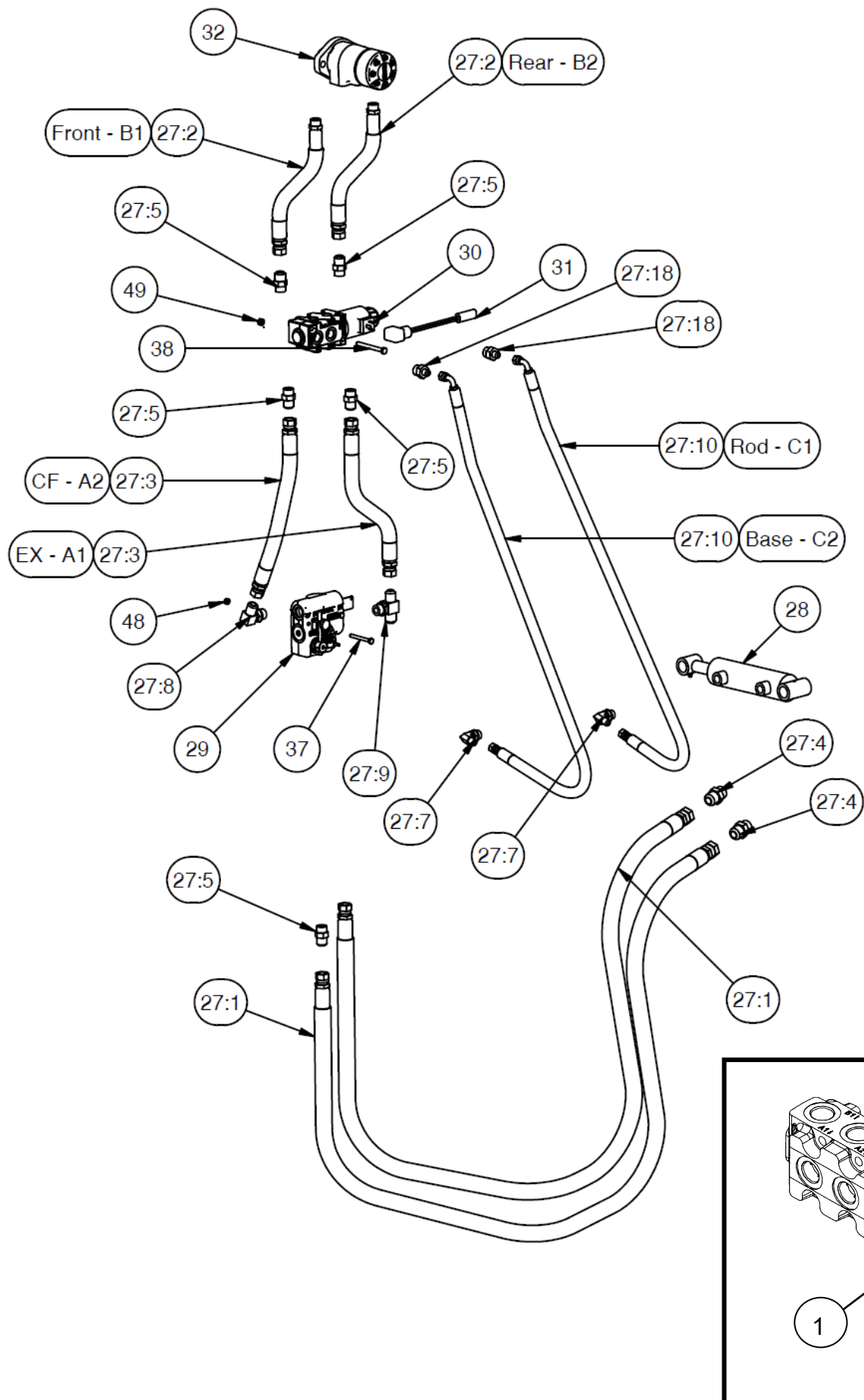



## HYDRAULIC ASSEMBLY

ITEM	QTY	PART NO.	DESCRIPTION	STOCK NO.
27	1	313490	HOSE KIT POST DRIVER TILT	
27:1	2	313396	HOSE 5/8 X 82 12FJX-10FJX	
27:2	2	313486	HOSE 5/8 X 15 10FJX-10MB	
27:3	2	313488	HOSE 5/8 X 16.5 10FJX-10FJX	
27:4	2	103431	ADPT STRAIGHT	12MB-12MJ
27:5	5	201852	ADPT STRAIGHT	10MB-10MJ
27:7	2	320089	ADPT ELBOW	8MB-6MJ-90
27:8	1	320144	ADPT ELBOW	10MB-10MJ-90
27:9	1	300235	ADPT TEE	10MJ-10MJ-10MB
27:10	2	313489	HOSE 3/8 X 54 6FJX-6FJX90	
27:18	2	320659	ADPT RESTRICTOR	10MB-6MJ .030"
28	1	400074	CYLINDER 2 X 4	
29	1	313311	VALVE FLOW CONTROL	
30	1	313467	VALVE 6-WAY	
31	1	313468	WIRE ADAPTER DIN	
32	1	313325	MOTOR HYD	
37	2	13013	BOLT HEX	1/4 X 2.5 UNC GR 5
38	2	13066	BOLT HEX	5/16 X 3-1/4 UNC GR 5
48	2	37210	NUT HEX LOCK	1/4 UNC GR 5
49	2	37211	NUT HEX LOCK	5/16 UNC GR 5

## POST DRIVER HYDRAULIC VALVE ASSEMBLY

ITEM	QTY	PART NO.	DESCRIPTION	STOCK NO.
	1	313467	VALVE 6-WAY SELECT ELEC	
1	1	313482	COIL VALVE 6-WAY PD	NIMCO
	1	313472	COIL VALVE 6-WAY PD	WALVOIL (OBLT)

**POST DRIVER PARTS INFORMATION**

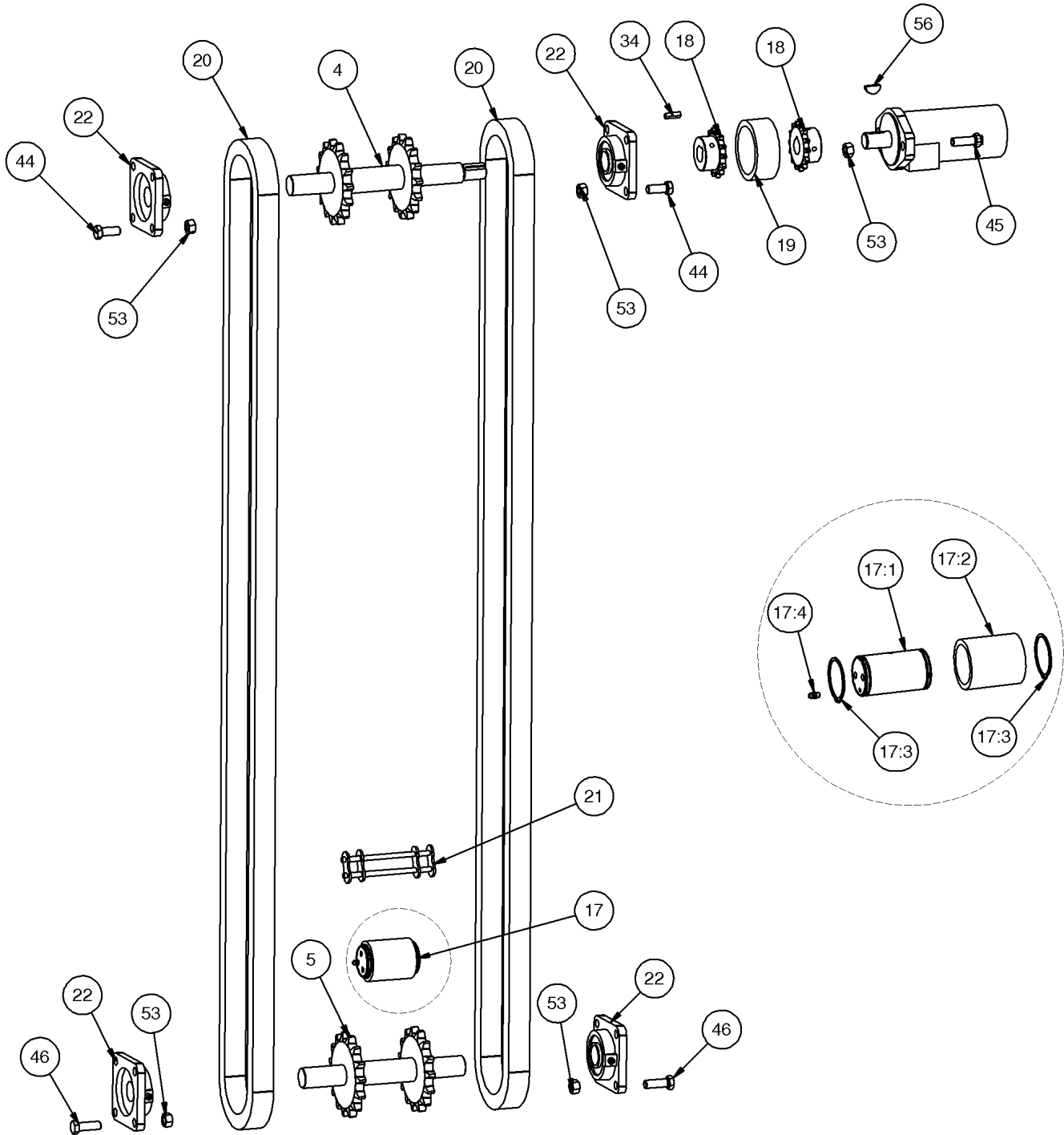

## DRIVE ASSEMBLY

ITEM	QTY	PART NO.	DESCRIPTION	STOCK NO.
4	1	313302	DRIVE SHAFT W/A	
5	1	313304	BOTTOM SHAFT W/A	
17	1	313300	CHAIN LIFT LINK ASY	
17:01	1	313360	SHAFT CHAIN LIFT	
17:02	1	313356	BUSHING CHAIN LIFT	
17:03	2	313333	RING SNAP EXT 2 X .063	
17:04	1	60105	STRAIGHT 1/4-28 UNF	
18	2	313323	SPROCKET 50B14 X 1B	
19	1	313322	CHAIN ROLLER NO 50-2X14 C/L	
20	2	313367	CHAIN ROLLER NO 80 X 129	
21	1	313368	CONN LINK NO 80 X 5	
22	4	316011	BRG 1-1/4 SM 4-B FLG	
34	1	300251	KEY SQ 1/4 X 1	
44	8	13207	BOLT HEX	1/2 X 1-1/4 UNC GR 5
45	2	22876	BOLT FLNG 12PT	1/2 X 1-1/2 UNC GR 5
46	8	13209	BOLT HEX	1/2 X 1-1/2 UNC GR 5
53	20	37214	NUT HEX LOCK	1/2 UNC GR 5
56	1	100540	KEY WOODRUFF 1/4 X 1	

# GENERIC WIRE HARNESS INSTALLATION

---

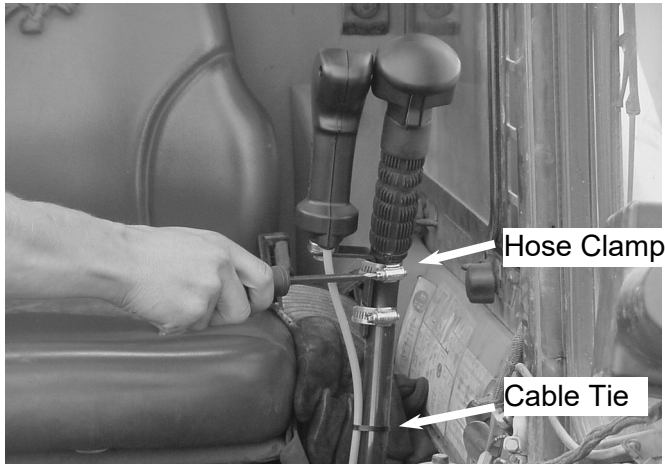

## Wire Harness Installation

A wire harness is needed to activate the tilt function. If the loader is equipped with an attachment control package, the appropriate harness should be installed from the factory.

If the post driver was ordered with the optional pistol grip control harness, follow these instructions:

1. Install the control handle on either steering lever, whichever you prefer, with (2) hose clamps.

**IMPORTANT:** The control handle bracket can be positioned several different ways. We recommend it be positioned as shown.

2. Put a cable tie around the wiring harness and the steering lever.
3. Install the wire harness receptacle bracket on either the loader arm or near the hydraulic quick couplers.

**IMPORTANT:** It may be necessary to make an adapter bracket in order to attach the wire harness to the loader.

4. Route the wire harness back along the tube lines on the loader arms and fasten with cable ties.



# GENERIC WIRE HARNESS INSTALLATION

5. Open the rear door. Pull the excess wire harness into the engine compartment.
6. Raise the operator cab. (See the loader's operator's manual for the correct procedure.)

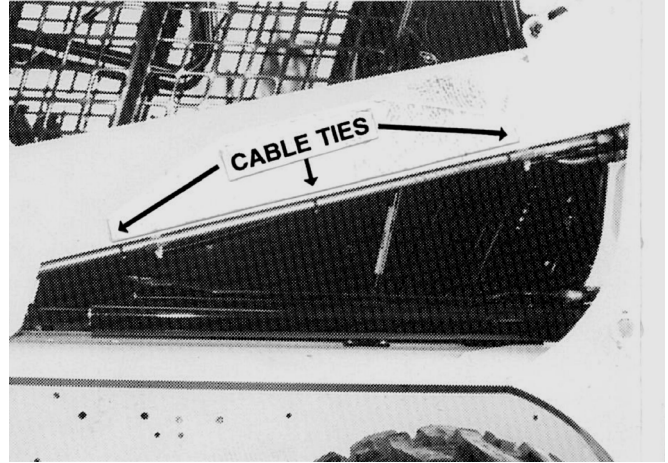

7. Connect the red fused wire to the positive battery terminal or to a suitable accessory wire with a minimum rating of 5 amps. Route the wiring along the loader main frame toward the front of the loader.

Connect the black wire from the harness to a frame ground.

8. Fasten the control handle wire harness connector to the main wire harness connector.

**NOTE:** Secure the wire harness in place with plastic cable ties, making sure it is clear of extra hot areas or any moving parts on the engine or loader. Pinched, stretched, or melted wire harnesses are not covered under warranty.

9. Lower the cab. (See the loader's operator's manual for the correct procedure.)

**NOTE:** Be sure the control handle wire harness is properly positioned as the cab is lowered.

For operating instructions, see page 17.

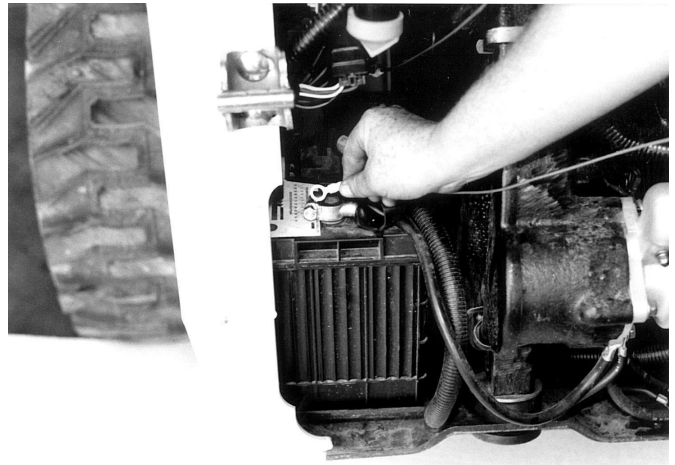

# POST DRIVER GENERAL SPECIFICATIONS

Overall Width	48.375"
Overall Height	83.875"
Overall Length	30.827"
Tilt (Both left and right)	18°
Post Size (Max)	8" x 9"
Post Size (Min)	"T" Post
Post Length (Max)	9 ft (depends on skid steer)
Post Driven Height (Min)	8" Above Ground Level
Hammer Weight	330 lbs
Hammer Weight w/ Ballast Option	520 lbs
Length of Hammer Stroke (Max)	57"
Blows per Minute (Max)	40
Hydraulic Requirements (Min)	10 GPM / 1,500 psi
Operating Weight	1000 lbs w/o Ballast

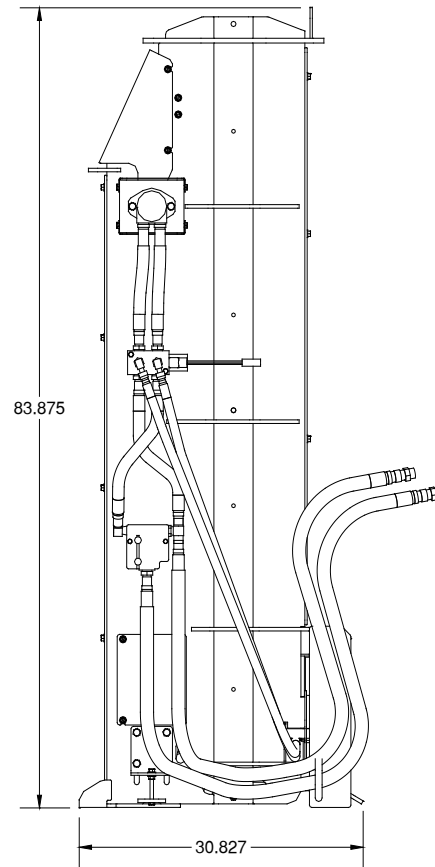
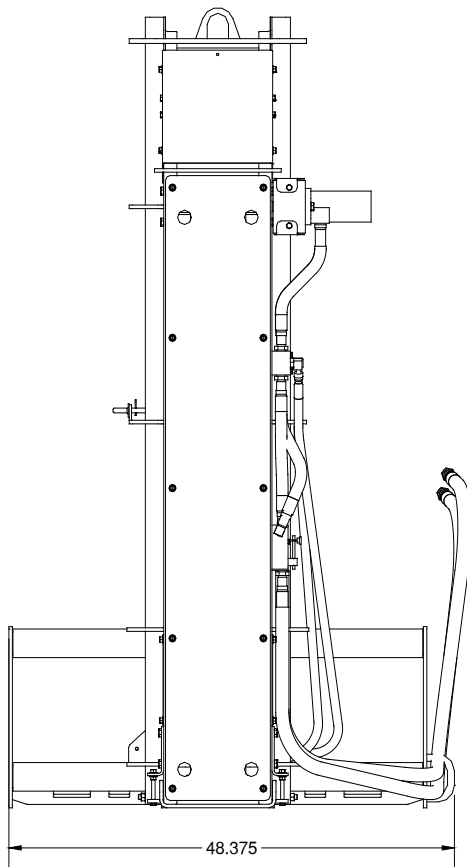

All dimensions are in INCHES.



## **LIMITED WARRANTY**

Erskine Attachments, LLC warrants each new machine manufactured by us to be free from defects in material and workmanship for a period of twenty-four (24) months from date of delivery to the original purchaser.

Our obligation under this warranty is to replace free of charge, at our factory or authorized dealership, any part proven defective within the stated warranty time limit.

All parts must be returned freight prepaid and adequately packaged to prevent damage in transit.

This warranty does not cover:

1. New products which have been operated in excess of rated capacities or negligence
2. Misuse, abuse, accidents or damage due to improperly routed hoses
3. Machines which have been altered, modified or repaired in any manner not authorized by our company
4. Previously owned equipment
5. Any ground engaging tools in which natural wear is involved, i.e. tooth tips, cutting teeth, etc
6. Normal maintenance
7. Fork tines
8. Hydraulic motors that have been disassembled in any manner

In no event will the Sales Representative, Dealership, Erskine Attachments, LLC, or any other company affiliated with it or them be liable for incidental or consequential damages or injuries, including but not limited to the loss of profit, rental or substitute equipment or other commercial loss. Purchaser's sole and exclusive remedy being as provided here in above.

Erskine Attachments, LLC must receive immediate notification of defect and no allowance will be made for repairs without our consent or approval.

This warranty is in lieu of all other warranties, express or implied by law or otherwise, and there is no warranty of merchantability or fitness purpose.

No agent, employee, or representative of Erskine Attachments, LLC has any authority to bind Erskine Attachments, LLC to any warranty except as specifically set forth herein. Any of these limitations excluded by local law shall be deemed deleted from this warranty; all other terms apply.

This warranty may not be enlarged or modified in any manner except in writing signed by an executive officer of Erskine Attachments, LLC to improve its products whenever it is possible and practical to do so. Erskine Attachments, LLC reserves the right to make changes and or add improvements at any time without incurring any obligation to make such changes or add such improvements to products previously sold.

Erskine Attachments, LLC  
P.O. Box 1083 Alexandria, MN 56308  
Phone (218) 435-4045



**P/N 313497**  
**Erskine Attachments LLC**

**Date Printed: 6/10/2022**

**Printed in U.S.A.**